

User Guide

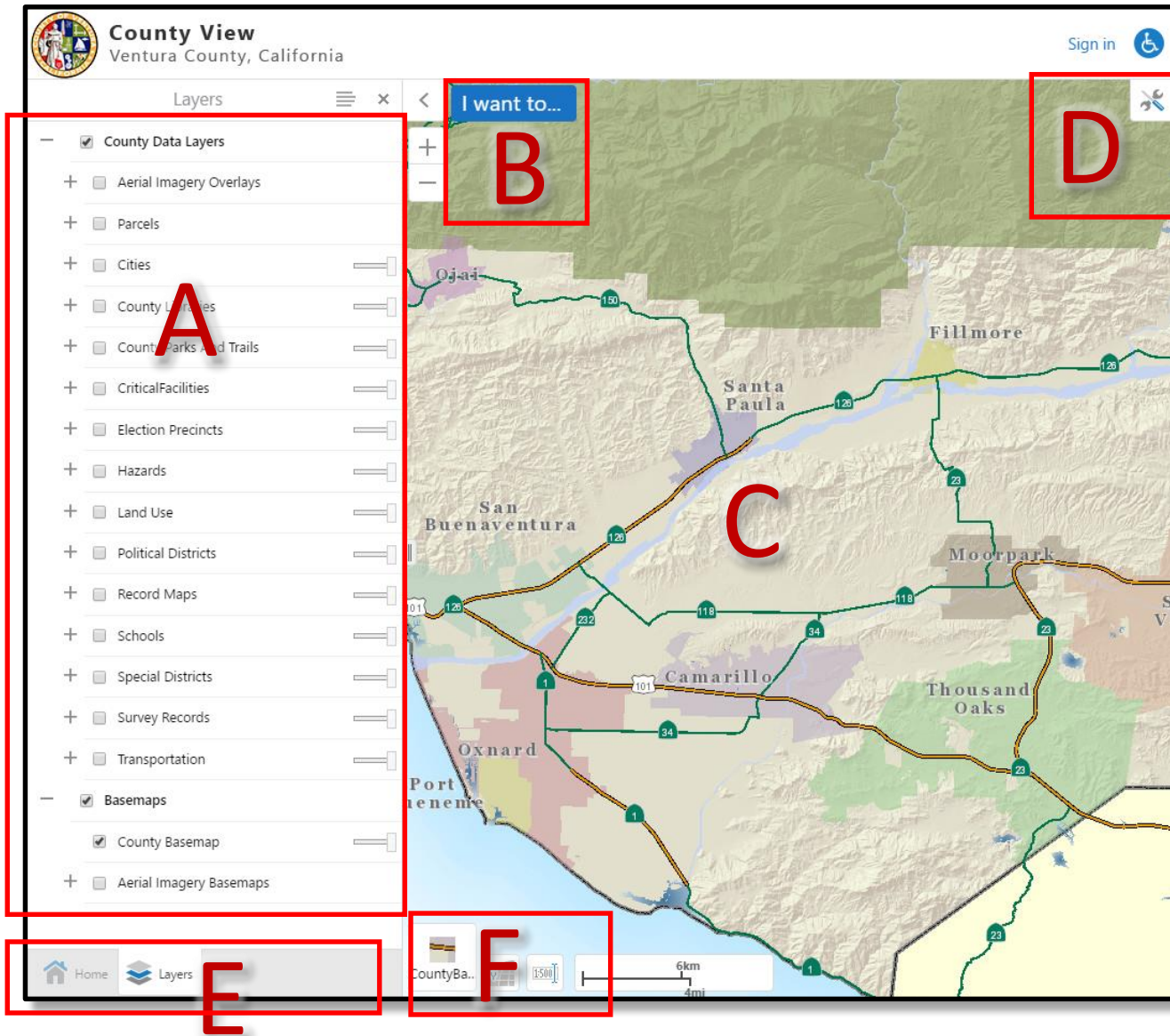

A Layers Table of Contents: Turn on and off layers.

B I Want to... : Access common operations

C The Map: Navigate the map by clicking and dragging and using the mouse scroll wheel to zoom.

D Click the tool icon to open the tool bar for more tools like searches and identify.

E Switch between tabs to view the Home Panel, Layers list, and Identify results.

F Click these icons to change the basemap, coordinate system, and scales.

Tip Hover the mouse pointer over icons to learn what they do.

For additional assistance or to provide us feedback, please contact us at gishelp@ventura.org

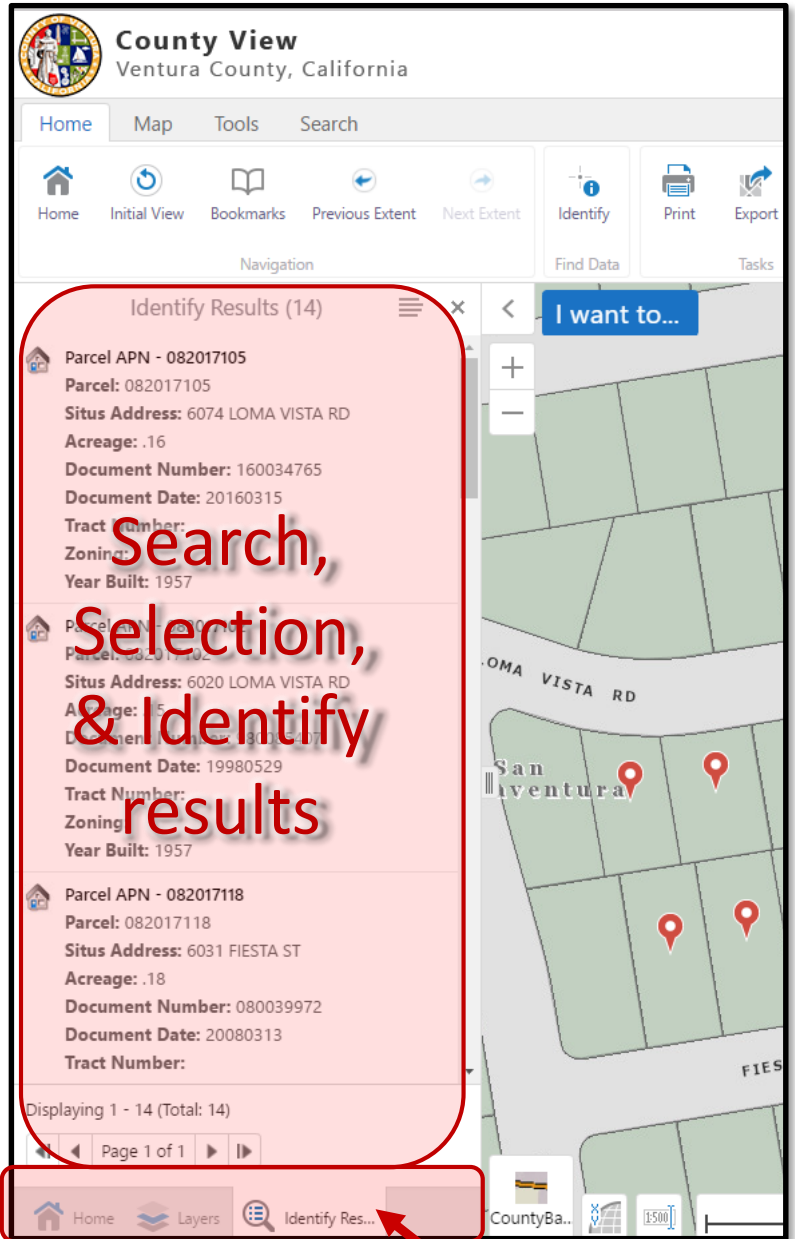

New Window Tabs appear here

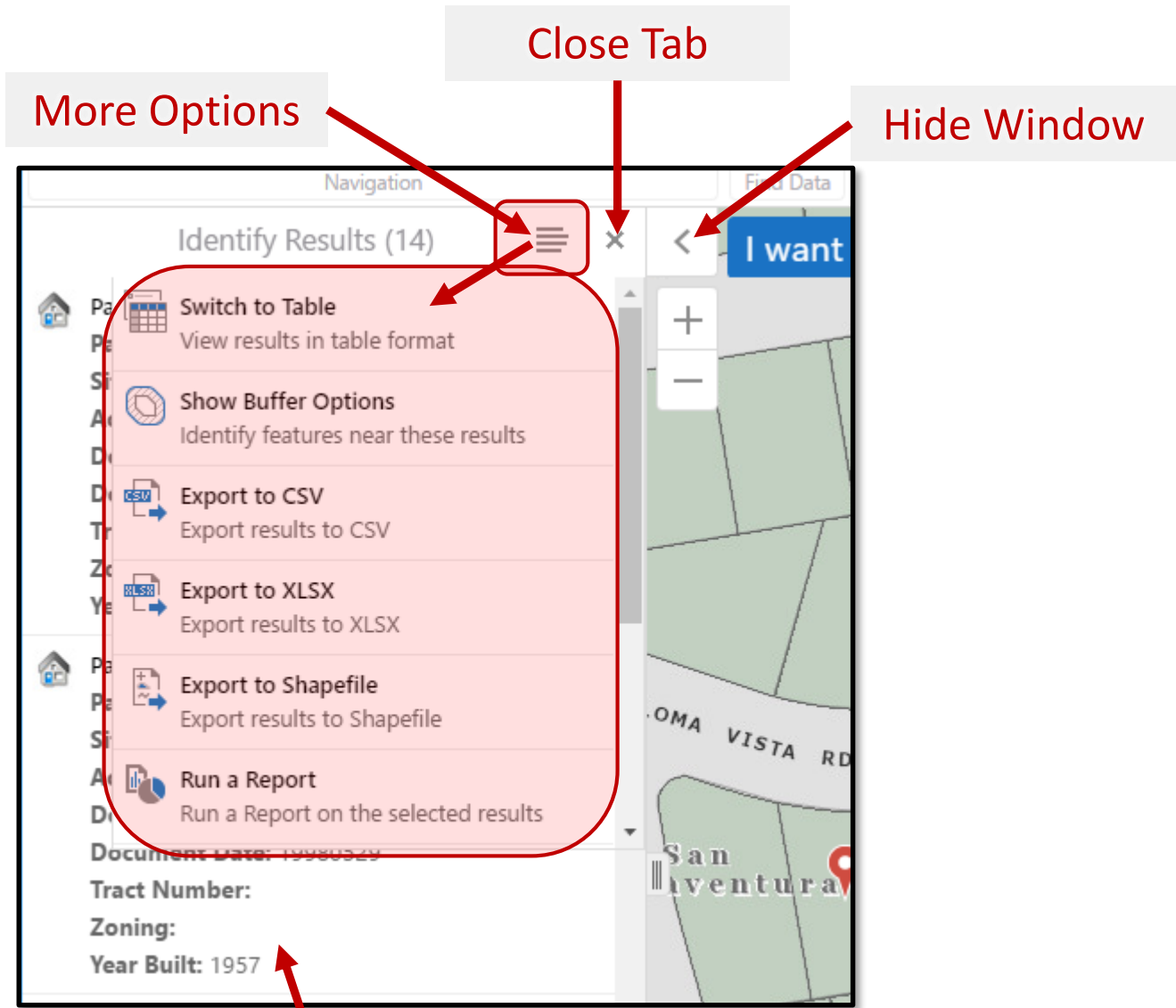

Left clicking an item will show more information about it

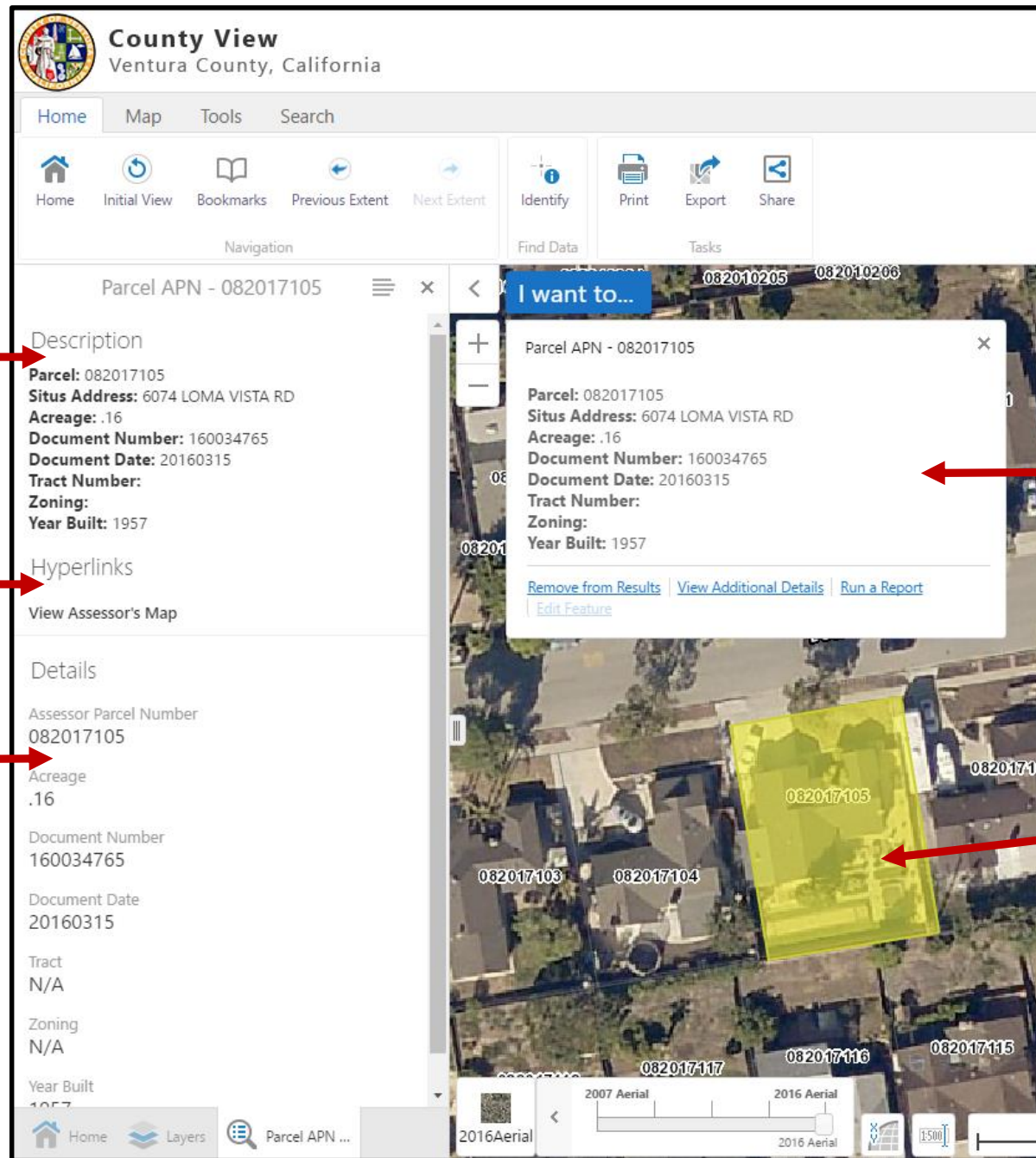

The feature's description

Hyperlinks are located here when available

Additional information about the feature

Left clicking a feature on the map to see its description

Selected features are highlighted

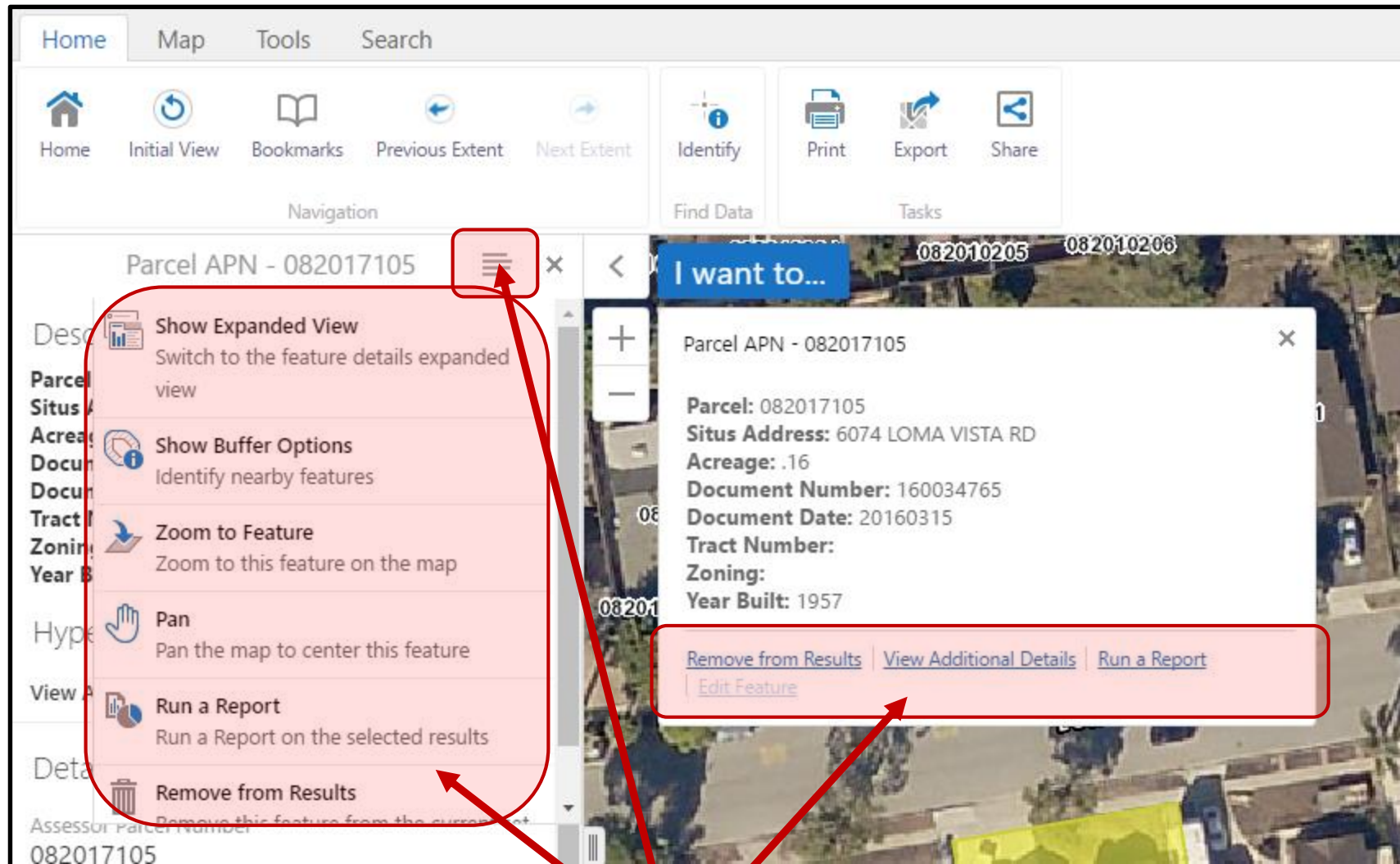

More Options when working
with a selected feature